

SITRANS F flowmeters

SITRANS F M

MAG 1100

Overview



The SITRANS F M MAG 1100 is an electromagnetic flow sensor in a compact wafer design designed for flow applications in the process industry.

Benefits

- Sensor sizes: DN 2 to 100 (1/12" to 4")
- Compact wafer design meets EN 1092, DIN and ANSI flange standards
- Corrosion resistant AISI 316 stainless steel sensor housing
- Highly resistant liner and electrodes fitting most extreme process media
- Temperature rating up to 200 °C (390 °F)
- Hose proof IP67/NEMA 4X/6 enclosure rating
- Designed that patented in-situ verification can be conducted. Using SENSORPROM fingerprints.

Application

The main applications of the SITRANS F M electromagnetic flow sensors can be found in the following fields:

- Process industry
- Chemical industry
- Pharmaceutical industry
- Water treatment like e.g. chemical dosing

Design

- Compact or remote mounting possible
- Easy "plug & play" field changeability of transmitter
- Simple on site upgrade to IP68/NEMA 6P
- Ex ATEX 2G D version
- CSA/FM Class 1 Div 2

Mode of operation

The flow measuring principle is based on Faraday's law of electromagnetic induction where the sensor converts the flow into an electrical voltage proportional to the velocity of the flow.

Integration

The complete flowmeter consists of a flow sensor and an associated transmitter SITRANS F M MAG 5000, 6000 or 6000 I. The flexible communication concept USM II simplifies integration and update to a variety of fieldbus systems such as HART, FOUNDATION Fieldbus H1, DeviceNet, PROFIBUS DP and PA, MODBUS RTU/RS 485.

Technical specifications

Version	MAG 1100	MAG 1100 HT (High temperature)
Measuring principle	Electromagnetic induction	Electromagnetic induction
Excitation frequency	DN 2 ... 65 (1/12" ... 2½"): 12.5 Hz DN 80, 100 (3", 4"): 6.25 Hz	DN 15 ... 50 (½" ... 2"): 12.5 Hz DN 80, 100 (3", 4"): 6.25 Hz
Process connection		
Nominal size		
• MAG 1100 (Ceramic)	DN 2 ... DN 100 (1/12" ... 4")	DN 15 ... DN 100 (½" ... 4")
• MAG 1100 (PFA)	DN 10 ... DN 100 (3/8" ... 4")	
Mating flanges	EN 1092-1 (DIN 2501), ANSI B 16.5 class 150 and 300 or equivalent Option: DN 2 ... 10 (1/12" ... 3/8"): G½" / NPT ½" pipe connection adapters	EN 1092-1 (DIN 2501), ANSI B 16.5 class 150 and 300 or equivalent
Rated operating conditions		
<u>Ambient conditions</u>		
Ambient temperature ¹⁾		
• Sensor	-40 ... +100 °C (-40 ... +212 °F)	-40 ... +100 °C (-40 ... +212 °F)
• Sensor ATEX	-20 ... +60 °C (-4 ... +140 °F)	-20 ... +50 °C (-4 ... +122 °F)
• Compact transmitter MAG 5000/6000	-20 ... +50 °C (-4 ... +122 °F)	
• Compact transmitter MAG 6000 I	-20 ... +60 °C (-4 ... +140 °F)	
• Compact transmitter MAG 6000 I Ex d	-10 ... +60 °C (+14 ... +140 °F)	
<u>Temperature of medium</u>		
• MAG 1100 (Ceramic)	-20 ... +150 °C (-4 ... +302 °F)	-20 ... +200 °C (-4 ... +392 °F)
• MAG 1100 ATEX (Ceramic)	-20 ... +150 °C (-4 ... +302 °F)	-20 ... +180 °C (-4 ... +356 °F)
• MAG 1100 (PFA)	-30 ... +130 °C (-20 ... +266 °F) Suitable for steam sterilization at 150 °C (302 °F)	
<u>Temperature shock</u>		
• MAG 1100 (Ceramic)		
- Duration ≤ 1 min, followed by 10 min rest	<ul style="list-style-type: none"> • DN 2, 3 (1/12", 1/8") No limitations • DN 6, 10, 15, 25: Max. ΔT ≤ 80 °C/min (¼", 3/8", ½", 1": Max. ΔT ≤ 80 K/min) • DN 40, 50, 65: Max. ΔT ≤ 70 °C/min (1½", 2", 2½"): Max. ΔT ≤ 70 K/min) • DN 80, 100: Max. ΔT ≤ 60 °C/min (3", 4"): Max. ΔT ≤ 60 K/min) 	<ul style="list-style-type: none"> • DN 15, 25: Max. ΔT ≤ 80 °C/min (½", 1": Max. ΔT ≤ 80 K/min) • DN 40, 50: Max. ΔT ≤ 70 °C/min (1½", 2": Max. ΔT ≤ 70 K/min) • DN 80, 100: Max. ΔT ≤ 60 °C/min (3", 4": Max. ΔT ≤ 60 K/min)
• MAG 1100 (PFA)	Max. ±100 °C (210 °F) momentarily	
<u>Operating pressure</u>		
• MAG 1100 (Ceramic)	<ul style="list-style-type: none"> • DN 2 ... 65: 40 bar (1/12" ... 2½"): 580 psi) • DN 80: 37.5 bar (3": 540 psi) • DN 100: 30 bar (4": 435 psi) Vacuum: 1×10^{-6} bar _{abs} (1.5×10^{-5} psi _{abs})	<ul style="list-style-type: none"> • DN 15 ... 50: 40 bar (½" ... 2"): 580 psi) • DN 80: 37.5 bar (3": 540 psi) • DN 100: 30 bar (4": 435 psi) Vacuum: 1×10^{-6} bar _{abs} (1.5×10^{-5} psi _{abs})
• MAG 1100 (PFA)	20 bar (290 psi) Vacuum: 0.02 bar _{abs} (0.3 psi _{abs}) DN 80 ... DN 100: CO ₂ pressure max. 7 bar (101.5 psi)	
<u>Mechanical load</u>		
	<ul style="list-style-type: none"> • 18 ... 1000 Hz random in x, y, z, directions for 2 hours according to EN 60068-2-36 • Sensor: 3.17 grms • Sensor with compact MAG 5000/ 6000 mounted transmitter: 3.17 grms • Sensor with compact MAG 6000 I/ 6000 I Ex mounted transmitter: 1.14 grms • For compact installation with the MAG 6000 I, transmitter to be supported to avoid tension on sensor part. 	<ul style="list-style-type: none"> • 18 ... 1000 Hz random in x, y, z, directions for 2 hours according to EN 60068-2-36 • Sensor: 3.17 grms
<u>Enclosure rating</u>		
• Standard	IP67 to EN 60529 (NEMA 4X/6), 1 mH ₂ O for 30 min	IP67 to EN 60529 (NEMA 4X/6), 1 mH ₂ O for 30 min
• Option on sensor (no ATEX)	IP68 to EN 60529 (NEMA 6P), 10 mH ₂ O cont.	IP68 to EN 60529 (NEMA 6P), 10 mH ₂ O cont.
EMC	89/336 EEC	89/336 EEC

SITRANS F flowmeters

SITRANS F M

MAG 1100

Design		
Weight	See Dimensional drawings	See Dimensional drawings
Material		
<ul style="list-style-type: none"> • Enclosure <ul style="list-style-type: none"> - MAG 1100 • Terminal box <ul style="list-style-type: none"> - Standard - Option • Fixing studs • Gaskets <ul style="list-style-type: none"> - Standard - Option • Pipe connection adapters: DN 2, 3, 6 and 10 (1/12", 1/8", 1/4" and 3/8") 	<p>Stainless steel AISI 316L (1.4404)</p> <p>Fibre glass reinforced polyamide (no ATEX) Stainless steel AISI 316 (1.4436)</p> <p>Stainless steel AISI 304 (1.4301), Number and size to EN 1092-1:2001</p> <p>EPDM (max. 150 °C, PN 40 (max. 300 °F, 600 psi))</p> <ul style="list-style-type: none"> • Graphite (max. 200 °C, PN 40 (max. 390 °F, 600 psi)) • PTFE (max. 130 °C, PN 25 (max. 270 °F, 300 psi)) • Stainless steel, AISI 316 • Hastelloy • PVDF 	<p>Stainless steel AISI 316L (1.4404)</p> <p>Stainless steel AISI 316 (1.4436)</p> <p>Stainless steel AISI 304 (1.4301), Number and size to EN 1092-1:2001</p> <p>Graphite (max. 200 °C, PN 40 (max. 390 °F, 600 psi))</p>
Liner		
<ul style="list-style-type: none"> • MAG 1100 (Ceramic) • MAG 1100 (PFA) 	<ul style="list-style-type: none"> • DN 2, 3 (1/12", 1/8"): Zirconium oxide (ZrO₂) (ceramic) • DN 6 ... 100 (1/4" ... 4"): Aluminium oxide Al₂O₃ Reinforced PFA (no ATEX) 	<p>DN 15 ... 100 (1/2" ... 4"): Aluminium oxide Al₂O₃</p>
Electrodes		
<ul style="list-style-type: none"> • MAG 1100 (Ceramic) • MAG 1100 (PFA) 	<ul style="list-style-type: none"> • DN10 ... 100 (3/8" ... 4") : Platinum with gold / Titanium brazing alloy • DN 2 ... 6 (1/12" ... 1/4"): Platinum • DN 10 ... 15 (3/8" ... 1/2"): Hastelloy C276 • DN 25 ... 100 (1" ... 4"): Hastelloy C22 	<p>Platinum with gold / Titanium brazing alloy</p>
Cable entries		
	<ul style="list-style-type: none"> • Remote installation 2 x M20 or 2 x 1/2" NPT • Compact installation <ul style="list-style-type: none"> - MAG 5000/MAG 6000: 4 x M20 or 4 x 1/2" NPT - MAG 6000I: 2 x M25 (for supply/output) - MAG 6000I Ex d: 2 x M20 (for supply/output) 	<p>Remote installation 2 x M20 or 2 x 1/2" NPT</p>
Certificates and approvals		
Conforms to	PED – 97/23 EC and CRN (PFA)	PED – 97/23 EC and CRN (PFA)
Ex approvals		
<p>MAG 1100 (Ceramic)</p> <ul style="list-style-type: none"> • ATEX sensor or Compact with MAG 6000 I Ex • Sensor with/without MAG 5000/6000 /6000 I <p>MAG 1100 (PFA)</p> <ul style="list-style-type: none"> • Sensor with/without MAG 5000/6000/6000 I 	<p>ATEX 2G D sensor Ex d e ia IIB T3 - T6</p> <p>CSA/FM Class 1 div 2</p> <p>CSA/FM Class 1 div 2</p>	<p>ATEX 2G D sensor Ex d e ia IIB T3 - T6</p> <p>CSA/FM Class 1 div 2</p>

¹⁾ Conditions are also dependent on liner characteristics

For technical specification for transmitter - please see transmitter pages.

Selection and Ordering data	Order No.
Sensor SITRANS F M MAG 1100 EPDM gaskets included	7ME6110 - A 0 -
Diameter	
DN 2 (1/12")	▶ 1 D
DN 3 (1/8")	▶ 1 H
DN 6 (1/4")	▶ 1 M
DN 10 (3/8")	▶ 1 R
DN 15 (1/2")	▶ 1 V
DN 25 (1")	▶ 2 D
DN 40 (1 1/2")	▶ 2 R
DN 50 (2")	▶ 2 Y
DN 65 (2 1/2")	▶ 3 F
DN 80 (3")	▶ 3 M
DN 100 (4")	▶ 3 T
Liner material	
PFA - DN 10 ... 100 (3/8" ... 4") (no ATEX)	▶ 1
Ceramic	▶ 2
Electrode material	
Hastelloy C (only with PFA liner)	▶ 1
Platinum (only with ceramic liner)	▶ 2
Transmitter	
Sensor for remote transmitter (order transmitter separately)	A
Sensor ATEX 2G D for remote transmitter (order transmitter separately)	B
MAG 6000 I, Aluminium 18 ... 90 V DC, 115 ... 230 V AC	C
MAG 6000 I, Aluminium 18 ... 30 V DC, ATEX 2G D	D
MAG 6000 I, Aluminium 115 ... 230 V, ATEX 2G D	E
MAG 6000 Polyamid, 11 ... 30 V DC / 11 ... 24 V AC	H
MAG 6000, Polyamid, 115/230 V AC	J
MAG 5000, Polyamid, 11 ... 30 V DC / 11 ... 24 V AC	K
MAG 5000, Polyamid, 115/230 V AC	L
Communication	
No communication, add-on possible	▶ A
HART	B
PROFIBUS PA Profile 3 (only MAG 6000/MAG 6000 I)	F
PROFIBUS DP Profile 3 (no ATEX) (only MAG 6000/MAG 6000 I)	G
MODBUS RTU/RS 485 (no ATEX) (only MAG 6000/MAG 6000 I)	E
FOUNDATION Fieldbus H1 (only MAG 6000/MAG 6000 I)	J
Cable glands/terminal box	
Metric: Polyamid terminal box or 6000I compact	▶ 1
1/2" NPT: Polyamid terminal box or 6000I compact	▶ 2
Metric: SS terminal box (mandatory for stainless steel MAG 6000 transmitter)	▶ 3
1/2" NPT: SS terminal box (mandatory for stainless steel MAG 6000 transmitter)	▶ 4
▶ Available ex stock	

Selection and Ordering data	Order code
Additional information	
Please add "-Z" to Order No. and specify Order code(s) and plain text.	
Customer specific converter setup	Y20
Tag name plate, stainless steel fixed with SS wire (add plain text)	Y17
Tag name plate, plastic (self adhesive)	Y18
Factory certificate according to EN 10204-2.1	C15
Factory certificate according to EN 10204-2.2	C14
Sensor cables wired (specify cable order no.)	Y40
Sensor for remote transmitter's junction box potted to IP68 with wired cable (specify cable order no.) (no ATEX sensors)	Y41
Other postproduction requirements (add desired text)	Y99

Selection and Ordering data	Order No.
Sensor SITRANS F M	
MAG 1100 HT High Temperature	7ME6120 - A 2 0 - 2 A
Ceramic liner, Platinum electrode, Graphite gaskets included	
Diameter	
DN 15 (1/2")	1 V
DN 25 (1")	2 D
DN 40 (1 1/2")	2 R
DN 50 (2")	2 Y
DN 80 (3")	3 M
DN 100 (4")	3 T
Transmitter	
Sensor for remote transmitter (order transmitter separately)	A
Sensor ATEX 2G D for remote transmitter (order transmitter separately)	B
Cable glands/terminal box	
Metric: SS terminal box	3
1/2" NPT: SS terminal box	4

Selection and Ordering data	Order code
Additional information	
Please add "-Z" to Order No. and specify Order code(s) and plain text.	
Customer specific converter setup	Y20
Tag name plate, stainless steel fixed with SS wire (add plain text)	Y17
Tag name plate, plastic (self adhesive)	Y18
Factory certificate according to EN 10204-2.1	C15
Factory certificate according to EN 10204-2.2	C14
Sensor cables wired (specify cable order no.)	Y40
Sensor for remote transmitter's junction box potted to IP68 with wired cable (specify cable order no.) (no ATEX sensors)	Y41

MAG 5000/6000 transmitters and sensors are packed in separate boxes, the final assembly takes place during installation at the customer's place. MAG 6000 I/MAG 6000 I Ex ATEX 2G D transmitters and sensors are delivered compact mounted from factory. Communication module will be premounted in the transmitter.

Please use online Product selector to get latest updates.

Product selector link:

www.pia-selector.automation.siemens.com

SITRANS F flowmeters

SITRANS F M

MAG 1100

Accessories

Order No.

for MAG 1100 sensor

Pipe connection 1/2" external thread

For DN 2 ... 10 (1/12" ... 3/8") sensor
2 pipe connections, 2 EPDM gaskets,
12 pcs M4 x 12 screws

- 1/2" G, ISO 7-1 tapered thread, SS 316 ▶ **FDK-083G0080**
- 1/2" G, ISO 7-1 tapered thread, Hastelloy C ▶ **FDK-083G4332**
- 1/2" NPT thread, SS 316 ▶ **FDK-083G4330**
- 1/2" NPT thread, Hastelloy C ▶ **FDK-083G4331**

For DN 2...10 (1/12" ... 3/8") sensor
2 PVDF pipe connections (Max. 70 °C,
PN 8 bar/max 158 °F, 116 PSI), 1 grounding
ring, 1 earthing wire, 3 PTFE gaskets, 6 pcs.
M4 x 12 and 6 pcs. M4 x 20 screws

- 1/2" G, ISO 7-1 tapered thread PVDF incl. grounding ring Hastelloy C22 **A5E01018395**
- 1/2" NPT thread PVDF incl. grounding ring Hastelloy C22 **A5E01018400**

EPDM gaskets

Material: EPDM; each set includes:
2 EPDM gaskets, 1 earthing wire, 1 M6 screw,
1 nut, 1 washer, 1 bolt earthing plate

- DN 2 ... 10, 1/12" ... 3/8" **FDK-083G3116**
- DN 15, 1/2" **FDK-083G3117**
- DN 25, 1" **FDK-083G3119**
- DN 40, 1 1/2" **FDK-083G3121**
- DN 50, 2" **FDK-083G3122**
- DN 65, 2 1/2" **FDK-083G3123**
- DN 80, 3" **FDK-083G3124**
- DN 100, 4" **FDK-083G3125**

PTFE gaskets

Material: PTFE; each set includes:
2 gaskets, 2 earthing wires, 3 M6 screws
(DN 2 ... DN 10: 12 pcs M4 x 14)

- DN 2 ... 10, 1/12" ... 3/8" **FDK-083G0156^{F)}**
- DN 15, 1/2" **FDK-083G0157^{F)}**
- DN 25, 1" **FDK-083G0159^{F)}**
- DN 40, 1 1/2" **FDK-083G0161^{F)}**
- DN 50, 2" **FDK-083G0162^{F)}**
- DN 65, 2 1/2" **FDK-083G0163^{F)}**
- DN 80, 3" **FDK-083G0164^{F)}**
- DN 100, 4" **FDK-083G0165^{F)}**

Graphite gaskets

Material: Graphite; conductive,
each set includes: 2 gaskets (conductive, can
also be used as grounding ring)

- DN 2 ... 10, 1/12" ... 3/8" **FDK-083G0116**
- DN 15, 1/2" **FDK-083G0117**
- DN 25, 1" **FDK-083G0119**
- DN 40, 1 1/2" **FDK-083G0121**
- DN 50, 2" **FDK-083G0122**
- DN 65, 2 1/2" **FDK-083G0123**
- DN 80, 3" **FDK-083G0124**
- DN 100, 4" **FDK-083G0125**

Grounding ring (S/S)

Material: AISI 316 (mat. no. 1.4436);
each set includes: 1 grounding ring, 3 teflon
gaskets, 1 earth strap, 1 M6 screw

- DN 2 ... 10, 1/12" ... 3/8" **FDK-083G0686**
- DN 15, 1/2" **FDK-083G0687**
- DN 25, 1" **FDK-083G0689**
- DN 40, 1 1/2" **FDK-083G0691**
- DN 50, 2" **FDK-083G0692**
- DN 65, 2 1/2" **FDK-083G0693**
- DN 80, 3" **FDK-083G0694**
- DN 100, 4" **FDK-083G0695**

Accessories

Order No.

for MAG 1100 sensor

Grounding ring (Hastelloy C)

Material: Hastelloy C22; each set includes:
1 grounding ring, 3 teflon gaskets, 1 earth
strap, 1 M6 screw

- DN 2 ... 10, 1/12" ... 3/8" **FDK-083G3256**
- DN 15, 1/2" **FDK-083G3257**
- DN 25, 1" **FDK-083G3259**
- DN 40, 1 1/2" **FDK-083G3261**
- DN 50, 2" **FDK-083G3262**
- DN 65, 2 1/2" **FDK-083G3263**
- DN 80, 3" **FDK-083G3264**
- DN 100, 4" **FDK-083G3265**

Grounding ring (Tantalum)

Material: Tantalum

- DN 2 ... 10, 1/12" ... 3/8" **A5E01181599^{F)}**
- DN 15, 1/2" **A5E01181606^{F)}**
- DN 25, 1" **A5E01181610^{F)}**
- DN 40, 1 1/2" **A5E01181613^{F)}**
- DN 50, 2" **A5E01181615^{F)}**
- DN 65, 2 1/2" **A5E01181616^{F)}**
- DN 80, 3" **A5E01181619^{F)}**
- DN 100, 4" **A5E01181622^{F)}**

Studs and nuts

for DN 100 PN 25/40, 8 M20 studs,
16 M20 nuts

- Material: AISI 304 (mat. no. 1.4305)
- DN 100, 4" **FDK-083G0226**

▶ Available ex stock

4

Dimensional drawings

Sensor MAG 1100, compact/remote

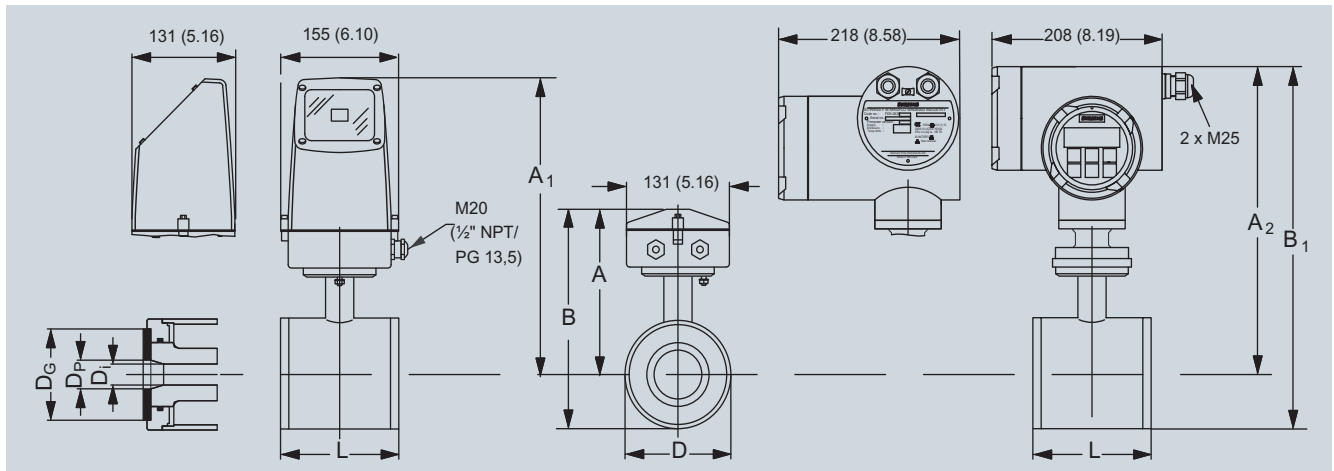
**Important note: For compact installation with MAG 6000 I/Ex - transmitter to be supported to avoid tension on the sensor part**

Size DN	A ¹⁾ [mm]	B ¹⁾ [mm]	A ₁ / A ₂ ³⁾ [mm]	B ₁ [mm]	D [mm]	D _i [mm]	D _i (PFA) [mm]	D _p [mm]	D _G [mm]	Weight ²⁾ [kg]
2	161	186	315	340	48.7	2		17.3	34	2.2
3	161	186	315	340	48.7	3		17.3	34	2.2
6	161	186	315	340	48.7	6		17.3	34	2.2
10	161	186	315	340	48.7	10	10	13.6	34	2.2
15	161	186	315	340	48.7	15	16	17.3	40	2.2
25	169	201	323	354	63.5	25	26	28.5	56	2.7
40	179	221	333	375	84.0	40	38	43.4	75	3.4
50	188	239	342	393	101.6	50	50	54.5	90	4.2
65	198	258	351	412	120.9	65	66	68.0	112	5.5
80	204	270	357	424	133.0	80	81	82.5	124	7.0
100	217	296	370	450	159.0	100	100	107.1	145	10.0

Size [inch]	A ¹⁾ [inch]	B ¹⁾ [inch]	A ₁ / A ₂ ³⁾ [inch]	B ₁ [inch]	D [inch]	D _i [inch]	D _i (PFA) [inch]	D _p [inch]	D _G [inch]	Weight ²⁾ [lbs]
1/12	6.34	7.33	12.40	13.39	1.92	0.08		0.68	1.34	4.8
1/8	6.34	7.33	12.40	13.39	1.92	0.12		0.68	1.34	4.8
1/4	6.34	7.33	12.40	13.39	1.92	0.24		0.68	1.34	4.8
3/8	6.34	7.33	12.40	13.39	1.92	0.39	0.39	0.53	1.34	4.8
1/2	6.34	7.33	12.40	13.39	1.92	0.59	0.63	0.68	1.57	4.8
1	6.66	7.92	12.72	13.94	2.50	0.98	1.02	1.12	2.20	4.9
1 1/2	7.05	8.70	13.11	14.76	3.31	1.57	1.50	1.71	2.95	7.5
2	7.40	9.41	13.47	15.47	4.00	1.97	1.97	2.15	3.54	9.2
2 1/2	7.80	10.16	13.82	16.22	4.76	2.56	2.60	2.68	4.41	12
3	8.03	10.63	14.06	16.70	5.24	3.15	3.19	3.25	4.88	15
4	8.54	11.65	14.57	17.72	6.26	3.94	3.94	4.22	5.91	22

¹⁾ 14.5 mm/0.57" shorter when the AISI terminal box is used (Ex or high temperature 200 °C (390 °F) version)

²⁾ With transmitter MAG 5000 or MAG 6000 installed, weight is increased by approximately 0.8 kg (1.8 lb).
With MAG 6000 I weight is increased with 5.5 kg (12.1 lbs).

³⁾ A₂ is 3 mm (0.12") shorter than A₁

SITRANS F flowmeters

SITRANS F M

MAG 1100

The total build-in length "L" [mm]/[inch] before assembling depends on the gasket selected

Size		EPDM		Graphite		PTFE (Teflon)		Without gasket		Earthing ring	
DN	Inch	[mm]	[inch]	[mm]	[inch]	[mm]	[inch]	[mm]	[inch]	[mm]	[inch]
2 ... 10 ¹⁾	1/12 ... 3/8	64	2.52	66	2.60	70	2.75	64	2.52	77	3.03
15	1/2	65	2.56	66	2.60	70	2.75	64	2.52	77	3.03
25	1	80	3.15	81	3.19	85	3.35	79	3.10	92	3.62
40	1 1/2	95	3.74	96	3.78	100	3.94	94	3.70	107	4.21
50	2	105	4.13	106	4.17	110	4.33	104	4.05	117	4.61
65	2 1/2	130	5.12	131	5.15	135	5.31	129	5.05	142	5.60
80	3	155	6.10	156	6.14	160	6.30	154	6.00	167	6.57
100	4	185	7.28	186	7.31	190	7.48	184	7.20	197	7.76

1) Mounting between two flanges

4

Sensor MAG 1100 DN 2 ... 10 (1/12" ... 3/8") with adapters

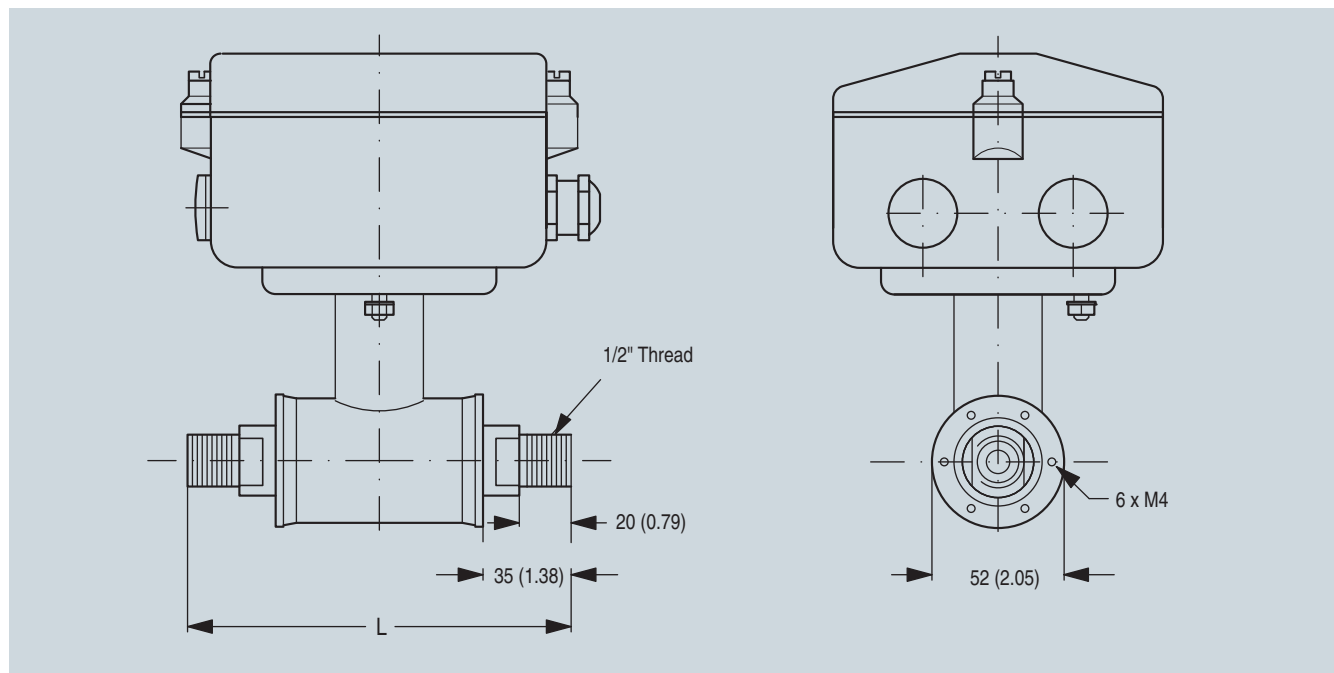

The MAG 1100 DN 2, 3, 6 and 10 (1/12", 1/8", 1/4" and 3/8") are prepared for assembly with the 1/2" pipe connections.

The length "L" varies dependent on the gasket choice.

Without gasket		EPDM		Graphite		Teflon	
[mm]	[inch]	[mm]	[inch]	[mm]	[inch]	[mm]	[inch]
150	5.9	150	5.9	152	6.0	156	6.1

Important note:

For compact installation with the MAG 6000 I, transmitter to be supported to avoid tension on sensor part.